

ENGINEERING SIMULATION SOLUTIONS - RAILWAY INDUSTRY

PRODUCT DEVELOPMENT WITH VIRTUAL PROTOTYPES

- LOWER DEVELOPMENT, TESTING, CERTIFICATION, WARRANTY & CALL-BACK COSTS
- DEVELOPMENT EFFICIENCY → FASTER GO-TO-MARKET TIME
- DESIGN OPTIMIZATION & MANAGING DESIGN COMPLEXITY
 - REDUCTION OF LABOUR, MATERIAL REQUIREMENTS & PHYSICAL VALIDATION COSTS
 - WEIGHT REDUCTION & SPEED CONTROL & EFFICIENCY
- IMPROVED FUNCTIONAL SAFETY & SECURITY
- ELECTRIFICATION & AUTONOMOUS SYSTEMS
- LIFE-TIME ESTIMATION
- JOINTS, COUPLINGS, SUSPENSION & BRAKE SYSTEMS - MULTI-BODY SIMULATIONS
- ADVANCED MATERIAL SOLUTIONS INCLUDING COMPOSITES
- NOISE, VIBRATION & HARSHNESS (NVH), THERMAL COMFORT ANALYSIS
- HEATING, VENTILATION AND AIR CONDITION (HVAC) SYSTEMS



FROM OUR PROJECTS



INSTRUMENT PANEL

- Quasi-static loadcases
- Layer optimization of polymer composite
- Evaluation of composite failure criteria

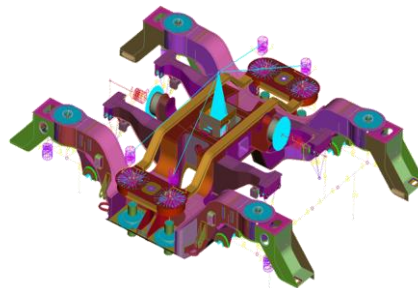

MOTOR BOGIE

- Standard load-case combinations
- Strength assessment
- Fatigue evaluation of welds

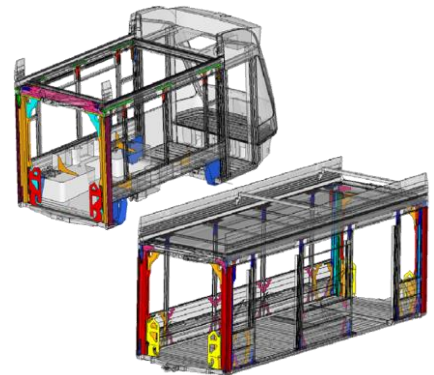

TRAM CALCULATION

- Stiffness and strength analysis
- Life-time estimation
- Mass-optimization

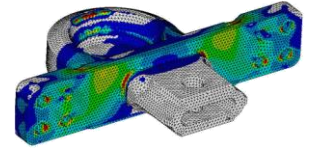

WHY eCON?

PROVIDING CUTTING-EDGE ENGINEERING SERVICES

- **18+ YEARS** EXPERTISE IN ENGINEERING SIMULATION & AUTOMATION SERVICES
- **70+ PROFESSIONAL ENGINEERS** WITH UP-TO-DATE KNOWLEDGE
- PROFESSIONAL ENGINEERING **SUPPORT** TEAM TO HELP YOU OUT
- NUMEROUS **INTERNATIONAL PROJECTS** IN DIFFERENT INDUSTRIES AND AREAS
- HIGHLIGHTED EXPERTISE IN **COMPOSITE** MATERIALS
- ADVANCED R&D COMPETENCIES, IN-HOUSE MEASUREMENT LABORATORY
- **TAILORED SOLUTIONS** FROM SIMPLE MODEL BUILDING THROUGH COOPERATION WITH IN-HOUSE CAE TEAMS, TO COMPLETE SIMULATION BACKGROUNDS
- **WIDE SIMULATION PORTFOLIO** COVERING ALL IMPORTANT AREAS AS:
 - STRUCTURAL (FINITE ELEMENT ANALYSIS)
 - FLUID (COMPUTATIONAL FLUID DYNAMICS ANALYSIS)
 - ELECTROMAGNETIC ANALYSIS
 - MULTIBODY SIMULATION (MBS)
 - 1D SYSTEM SIMULATION
 - INJECTION MOLDING SIMULATIONS
 - METHOD DEVELOPMENT
- eCON IS AN INDUSTRIAL **AUTOMATION** EXPERT (AS PRIME CONTRACTOR), CAPABLE OF OFFERING COMPLETE SCALE OF PRODUCT DEVELOPMENT PROCESS

SOME OF OUR REFERENCES



CERTIFICATES & AWARDS

